

Compass Applet User Guidebook

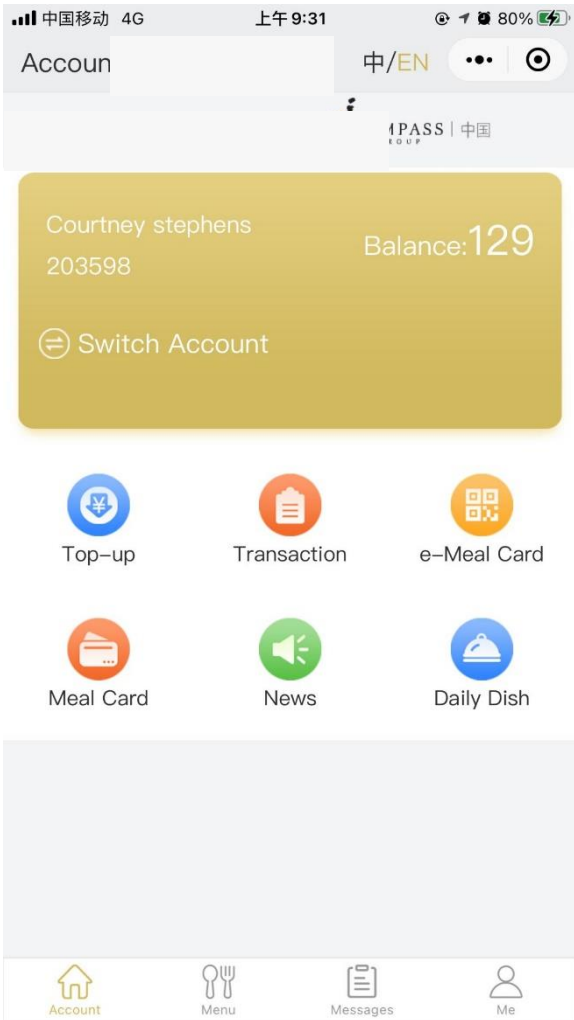

Function	Description
Switch Account	Consumers/Parents could switch to different account
Top-up	Consumers/Parents could do online top-up
Transaction	Consumers/Parents could inquire transactions
e-Meal Card	Consumers/Pupils could use e-Meal card for consumption
Meal Card	Consumers/Parents could manage meal card via Applet (Frozen/Unfreeze Card)
News	Consumers/Parents could check updated news provides by catering
Daily Dish	Consumers/Parents could view the daily dish picture
Menu	Consumers/Parents could check the updated menu
Messages	Consumers/Parents could review the message pushed by system (include top-up, consumption, balance notifications)

Function	Description
Me	Consumers/Parents could update individual information <ul style="list-style-type: none"> ● Profile: name, e-mail address, mobile phone number ● Account Management: unbind account ● Limitation Amount: Set up daily consumption limitation amount ● Message Setting: Set up the auto-notification for consumption, top-up, refund, and balance ● User Guide: the Appletlet guidebook for different functions

Tips: Applet is Mini Program in WeChat, consumers/parents DO NOT need to install additional App.

1. Display language follows up with setting of WeChat
2. If it doesn't work properly, please click the button to switch language.

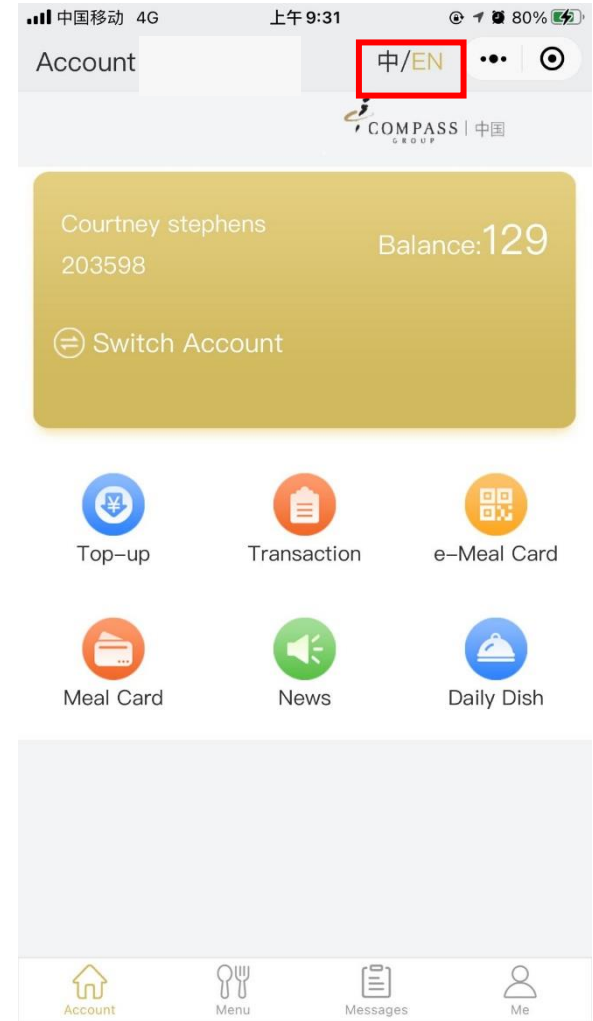

1. Bind Account
2. Top up
3. Transaction Inquiry
4. e-Meal Card
5. Meal Card Management
6. Consumer Interaction
7. Personal Profile

Consumers/Parents shall bind account for using functions in Applet. There are two ways for binding account:

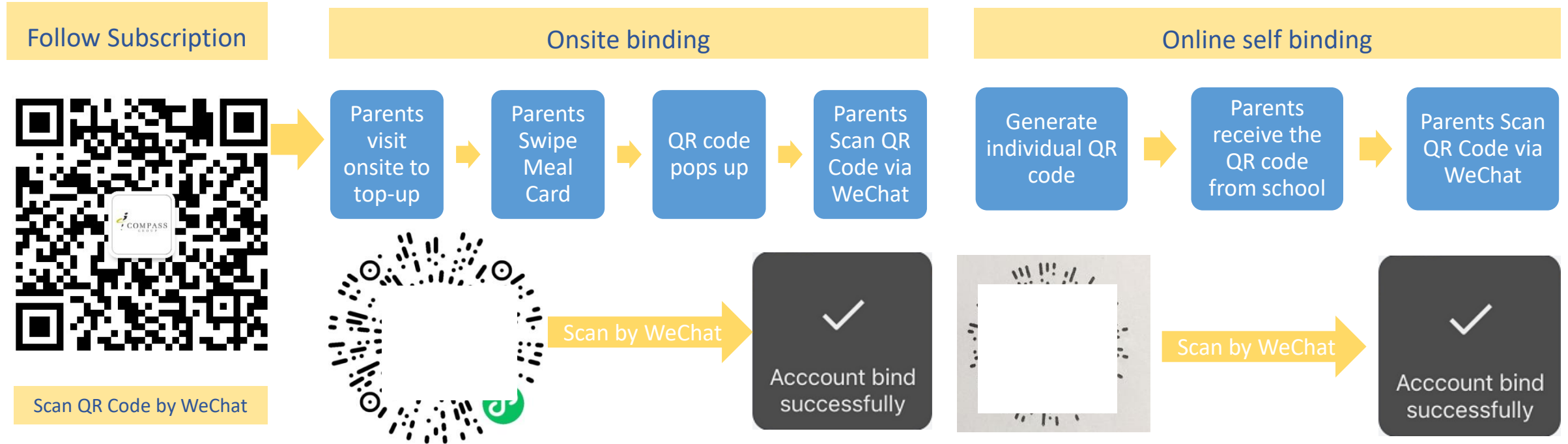

Tips:

1. Each account has individual QR code for you to bind your own account.

Consumers/Parents could switch account if have multi accounts.

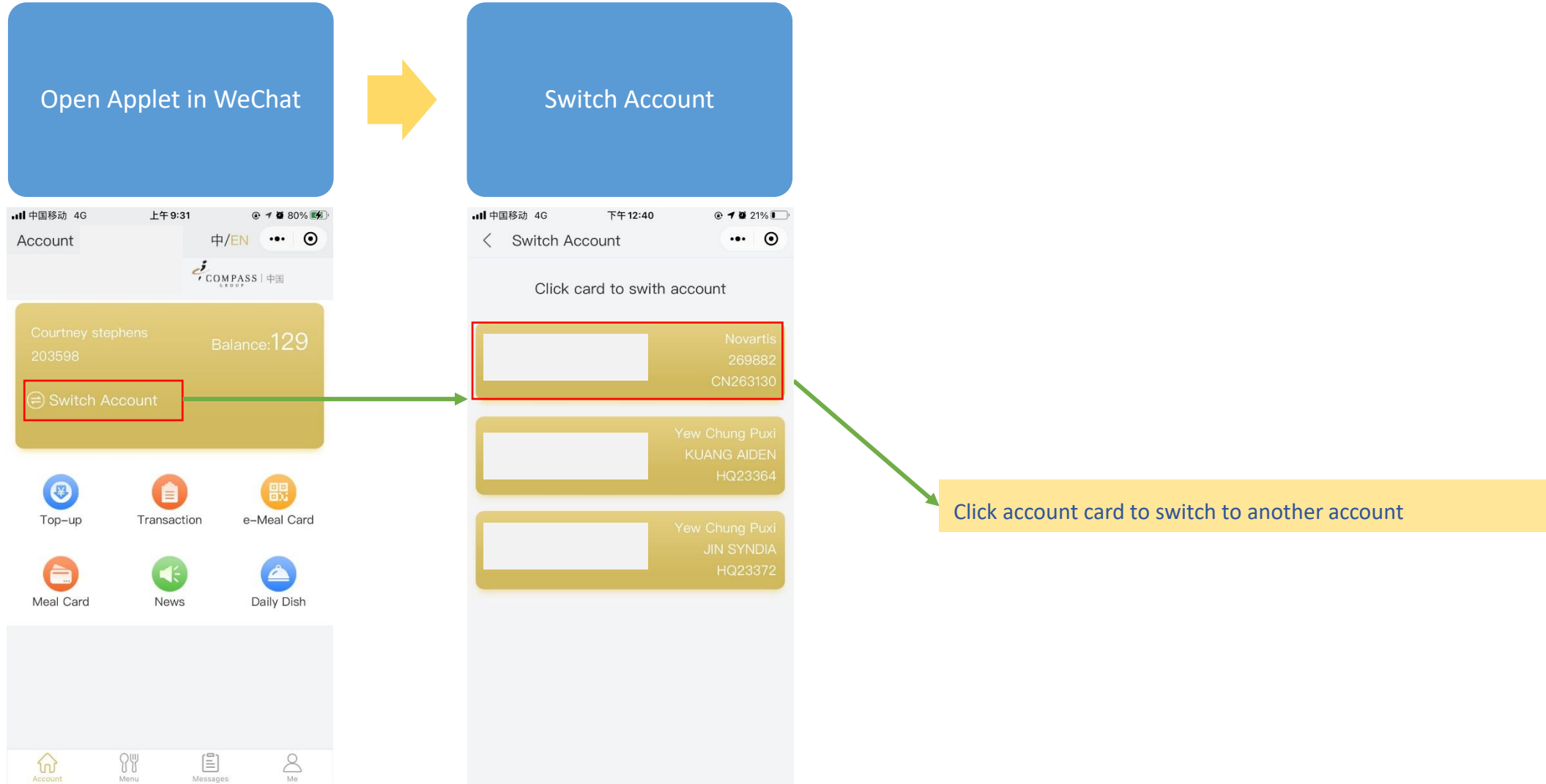

Consumers/Parents can top-up remotely via Applet.

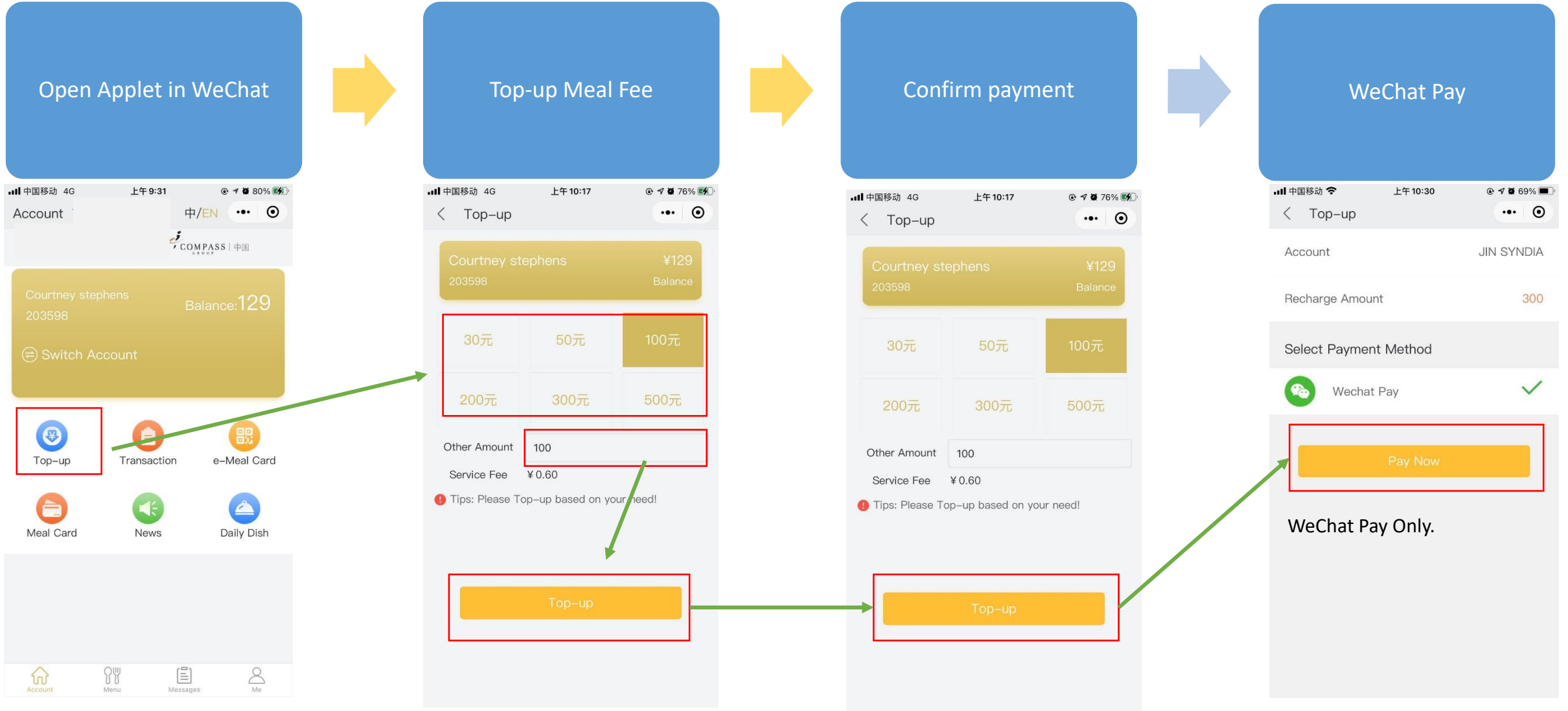

Consumers/Parents can inquiry transactions via Applet.

Open Applet in WeChat



Inquiry Transaction

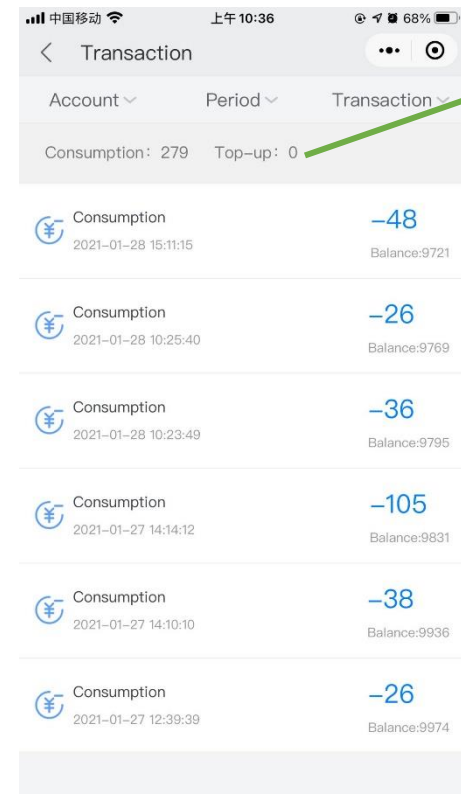
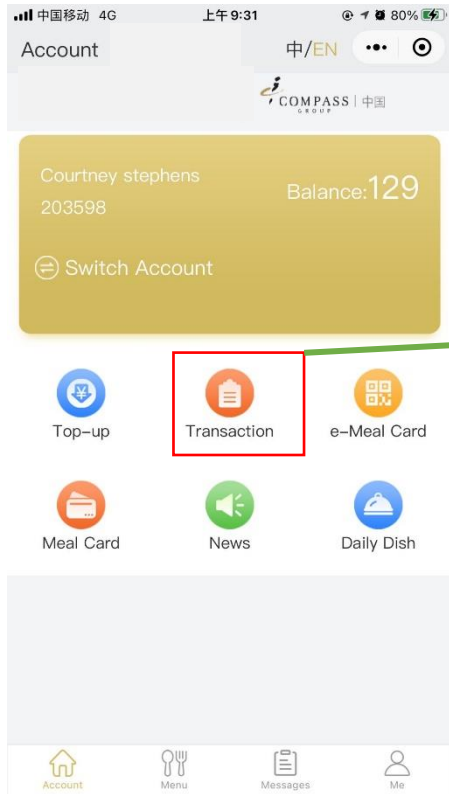

Up-to-date total consumption and top-up amount

Consumers/Parents can use e-Meal Card via Applet for consumption instead of physical meal card.

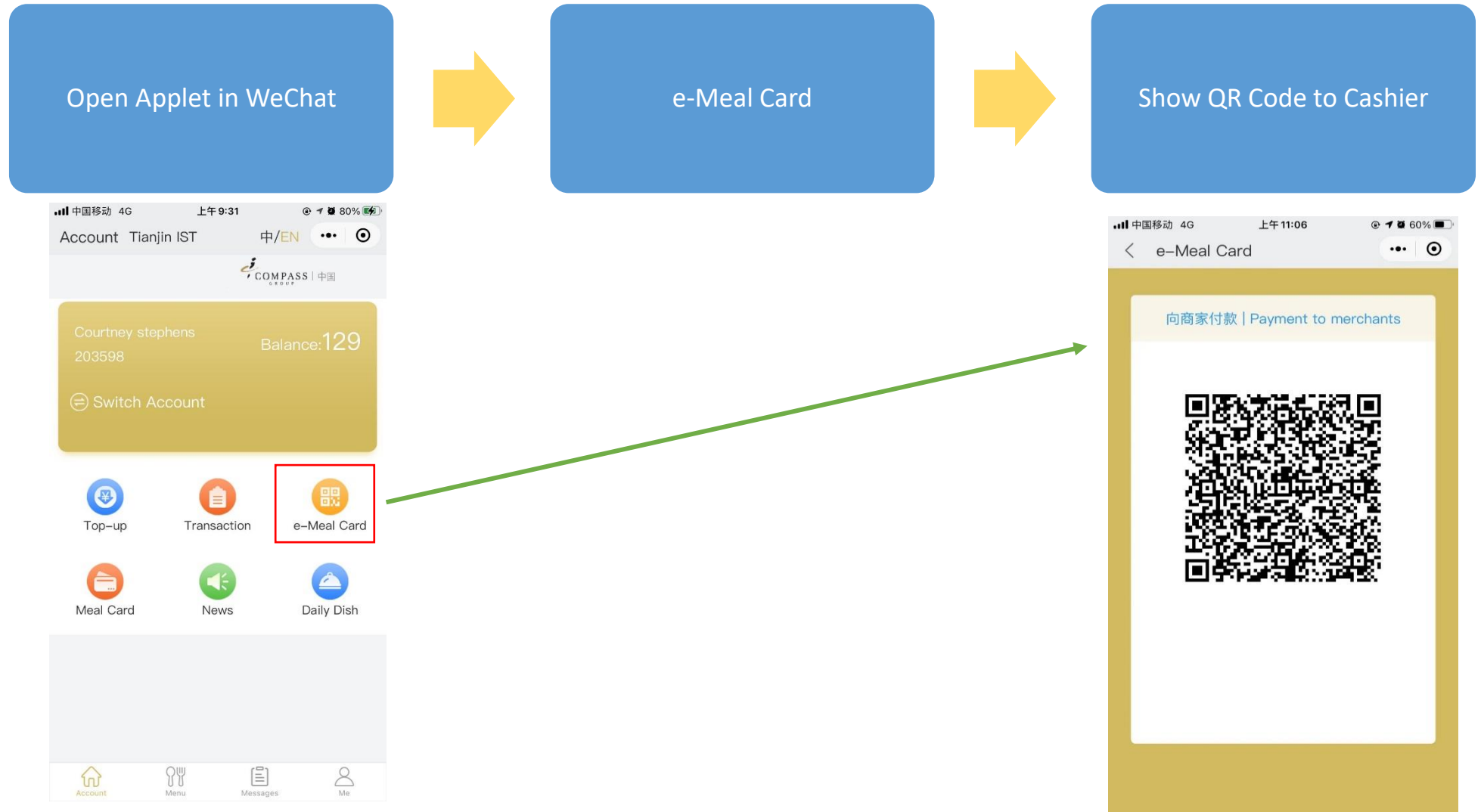

Consumers/Parents can manage meal card self via Applet (Frozen/Unfreeze card).

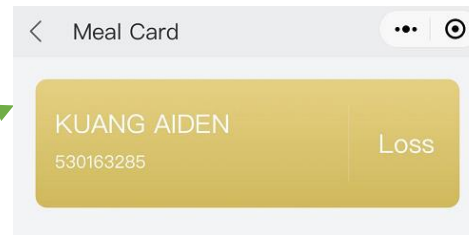
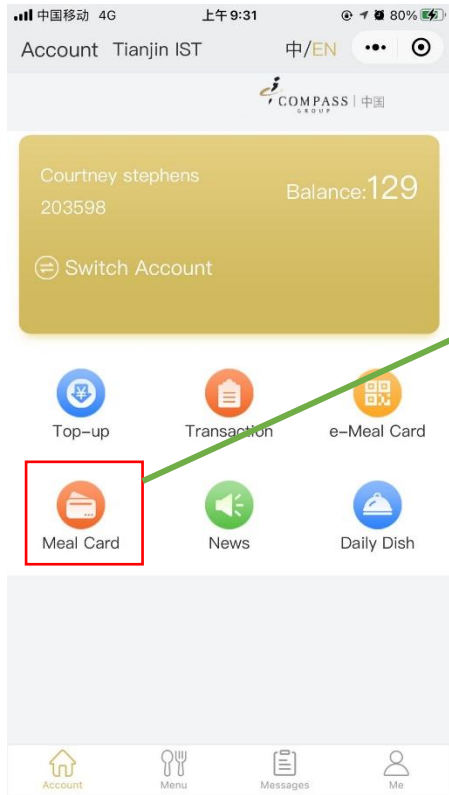

Tips
Report the loss of the meal card so that the meal card can't be used anymore, please make sure?

Cancel [Confirm](#)

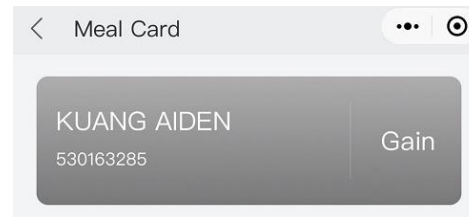

Tips
Are you sure to gain the meal card?

Cancel [Confirm](#)

1. Menu
2. Daily Dish
3. News
4. Messages

Consumers/Parents could visit weekly menu by clicking "Menu".

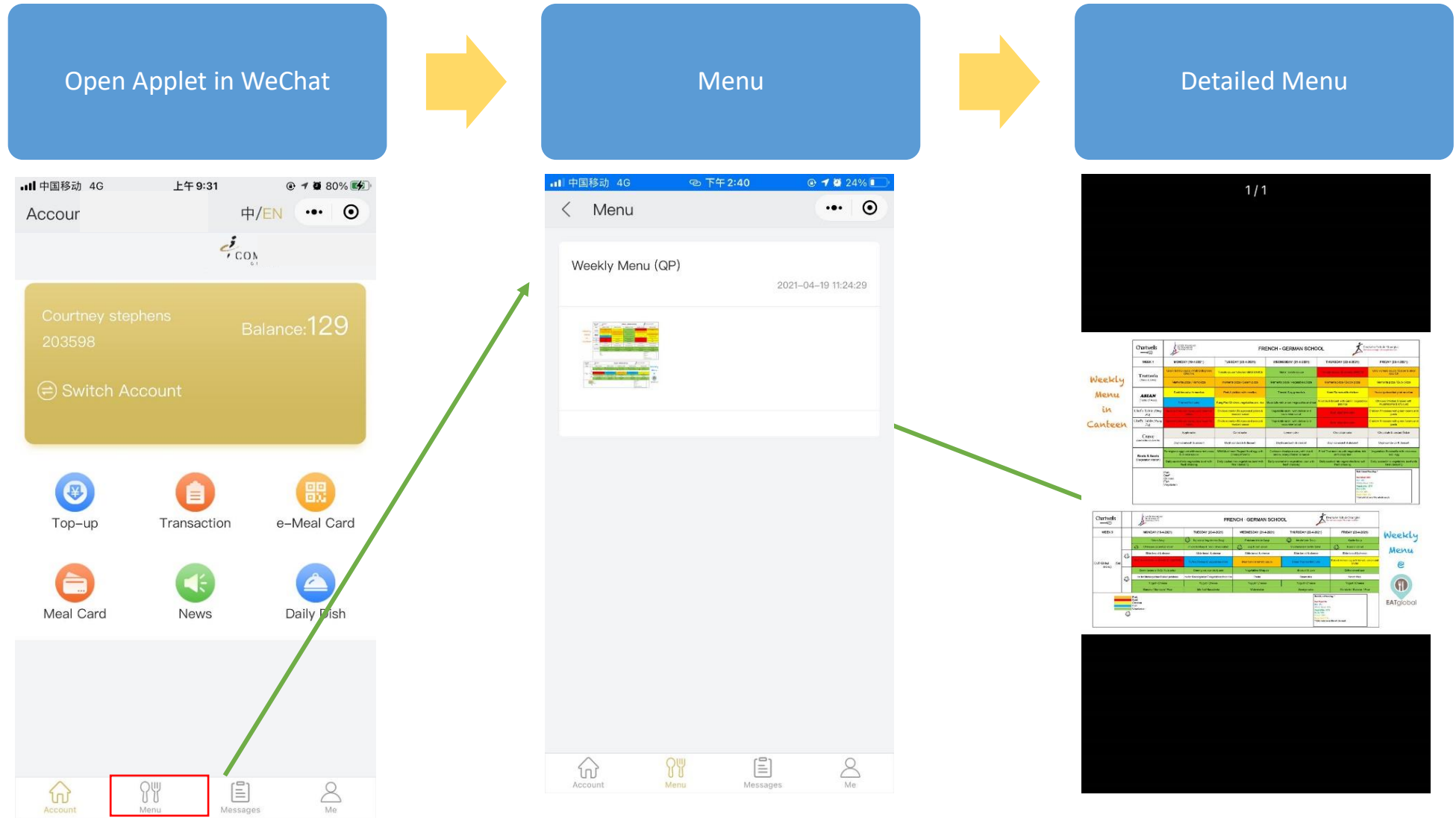

Consumers/Parents could check the pictures of daily dishes by clicking "Daily Dish".

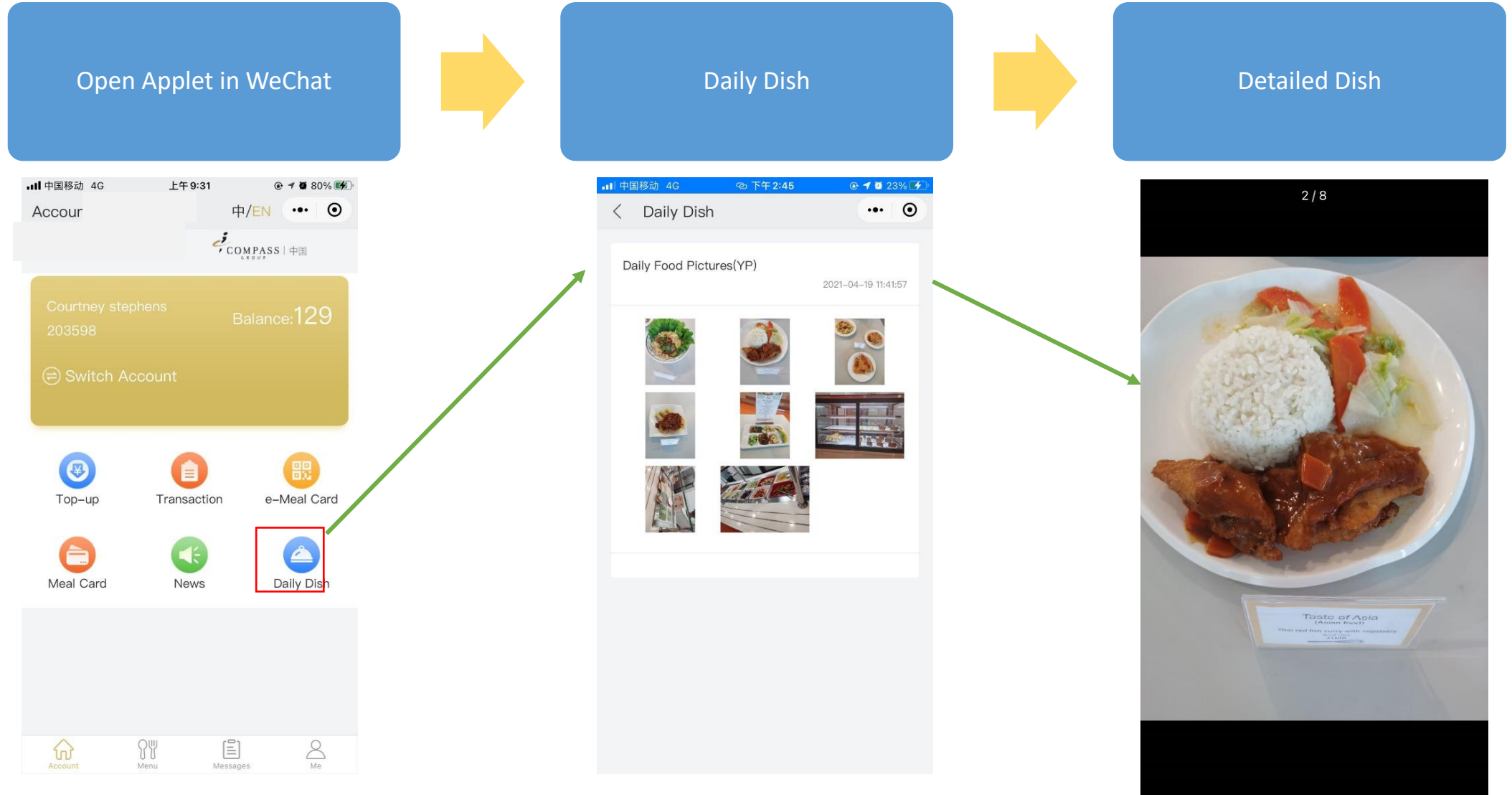

Consumers/Parents could read the catering news by clicking "News".



Consumers/Parents could review the message sent by system.

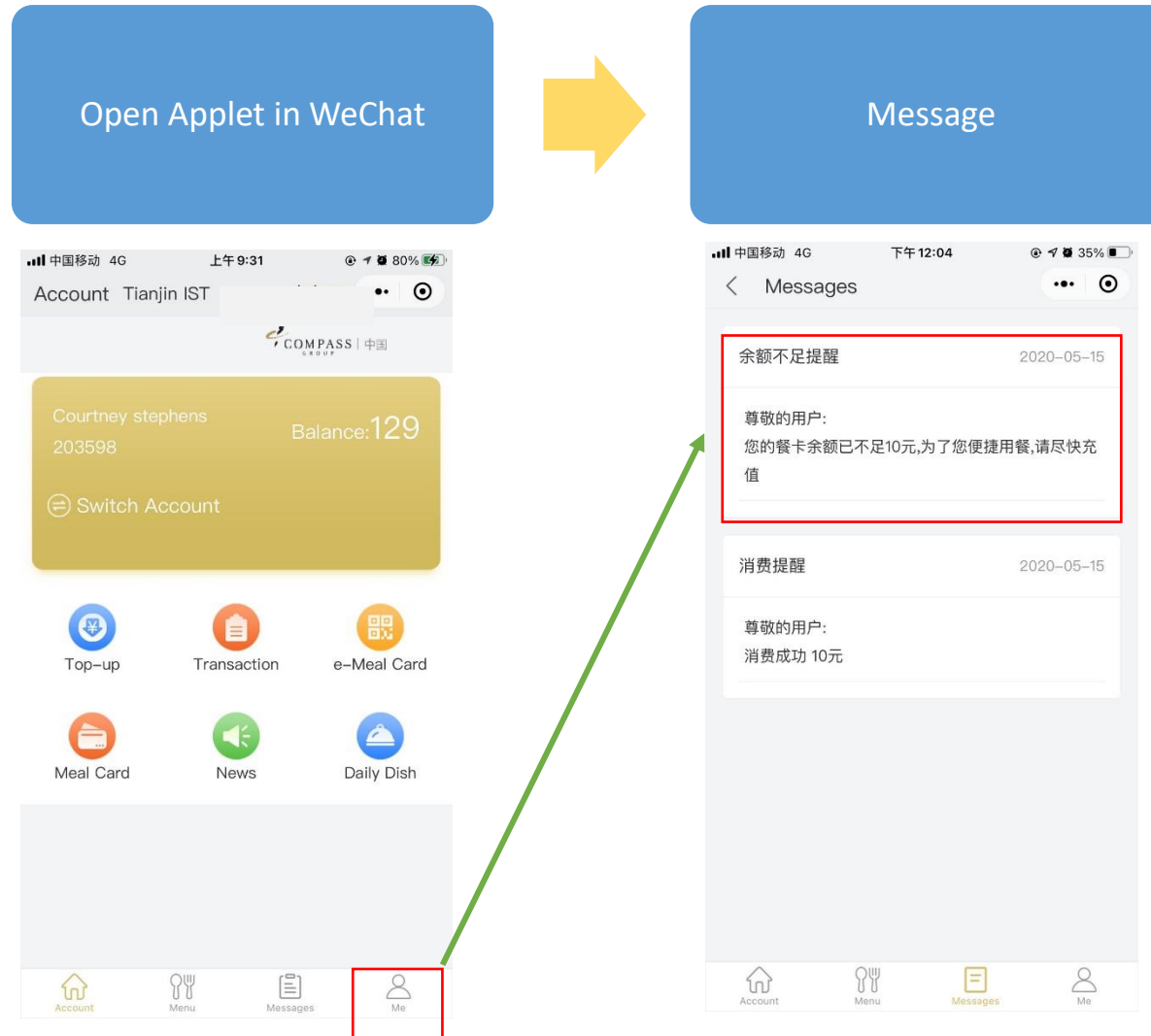

- Tips:
- ✓ Messages will be pushed base on real time top-up and consumption transactions
 - ✓ Out of credit notification will be pushed by system

1. My Profile
2. Account Management
3. Daily Limitation
4. Message Settings
5. User Guide

Consumers/Parents could update personal profile information via Applet.

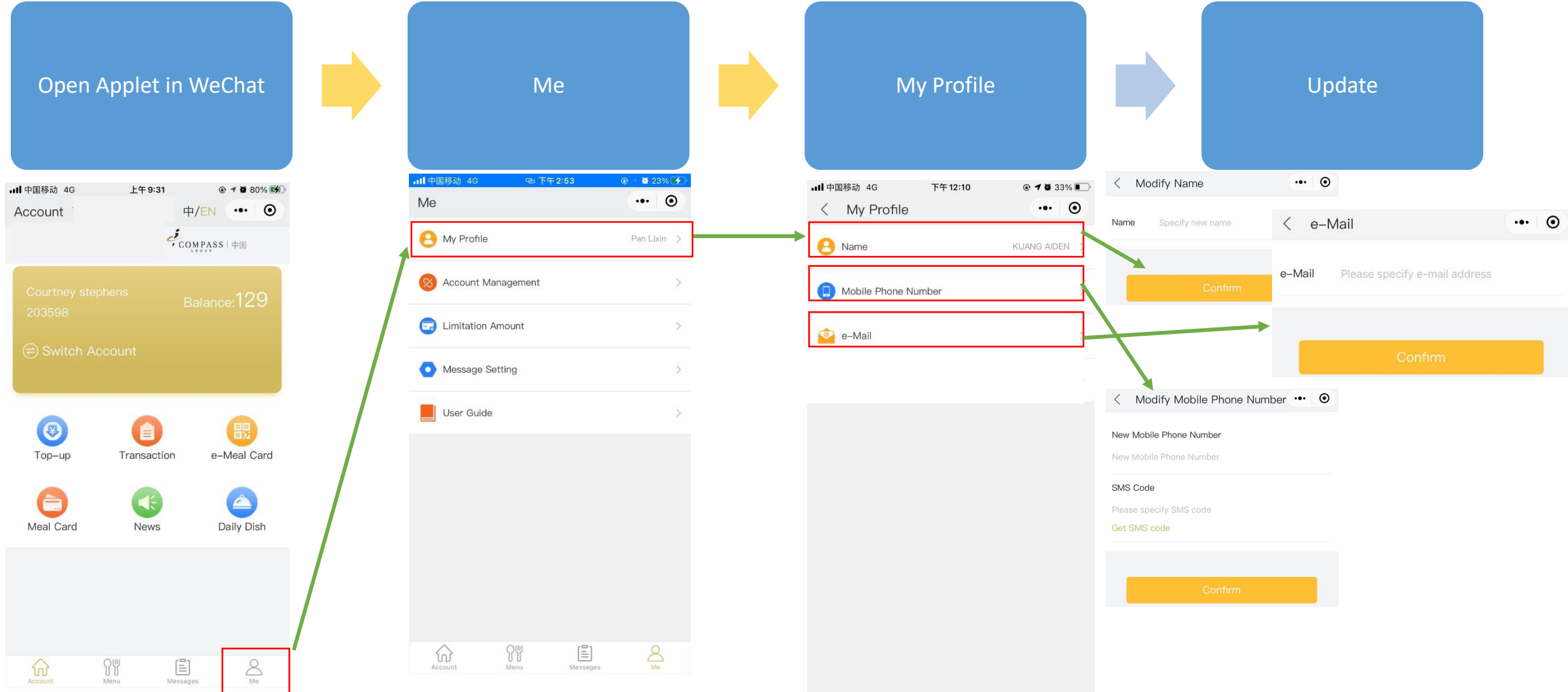

Consumers/Parents could unbind account if stop using it.

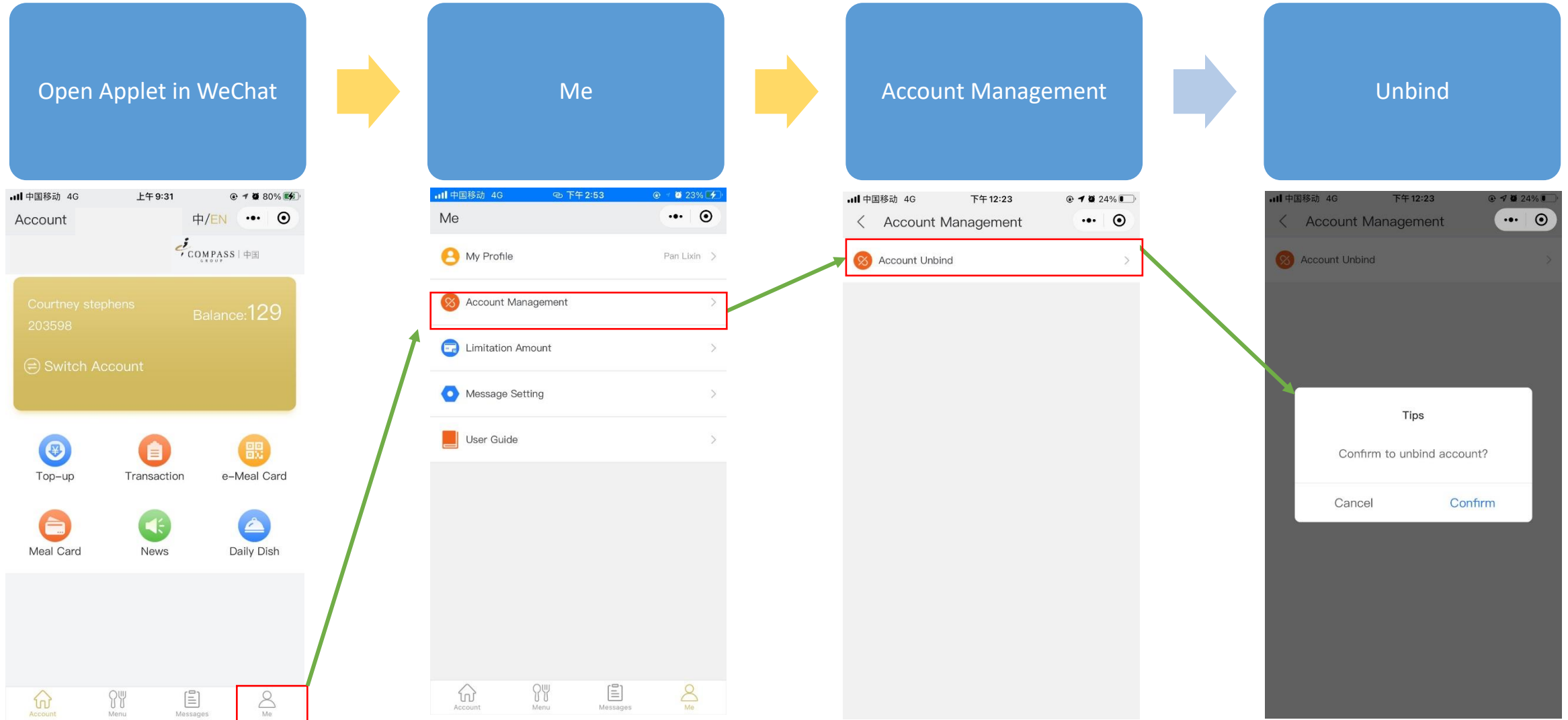

Consumers/Parents could setup daily consumption limitation amount.

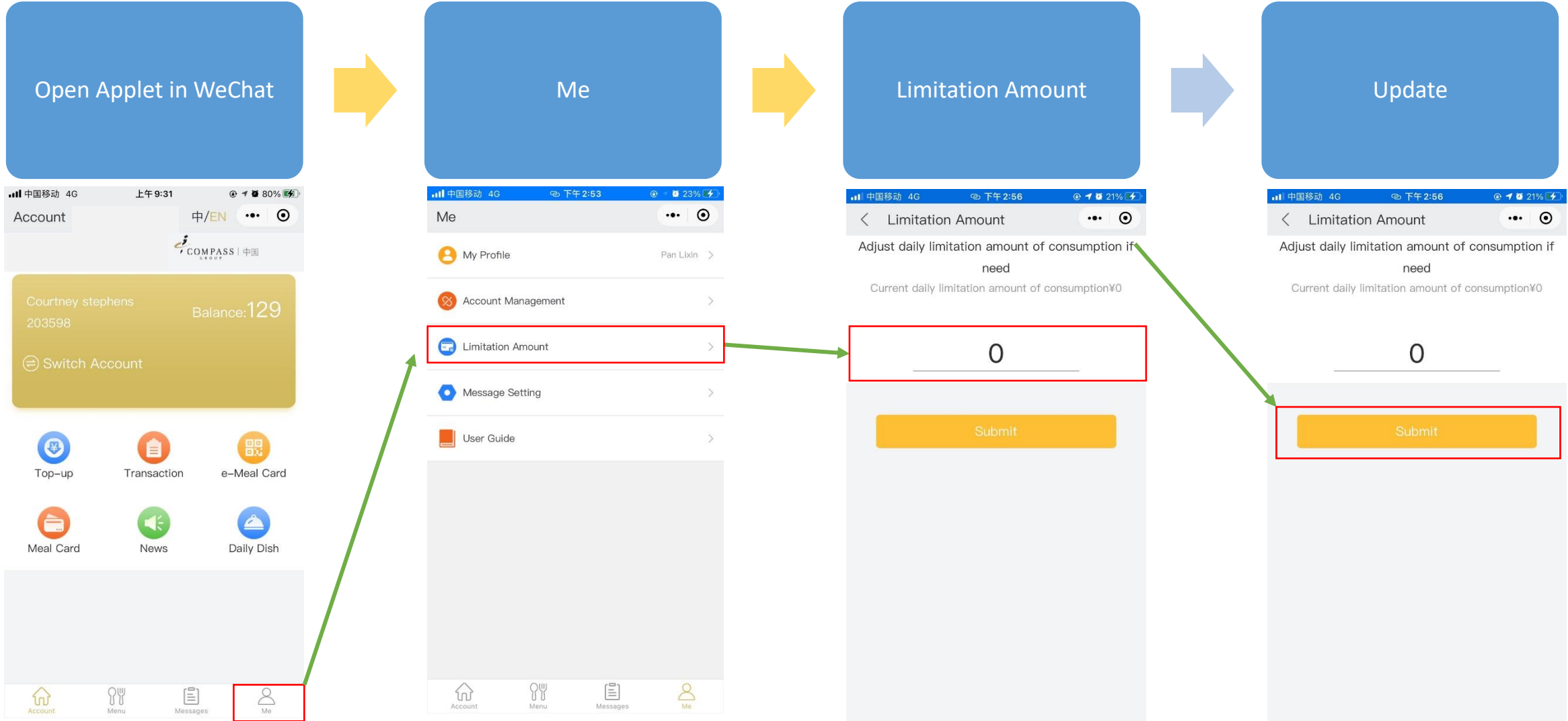

Consumers/Parents could set up the auto-notification for consumption, top-up, refund, and balance.

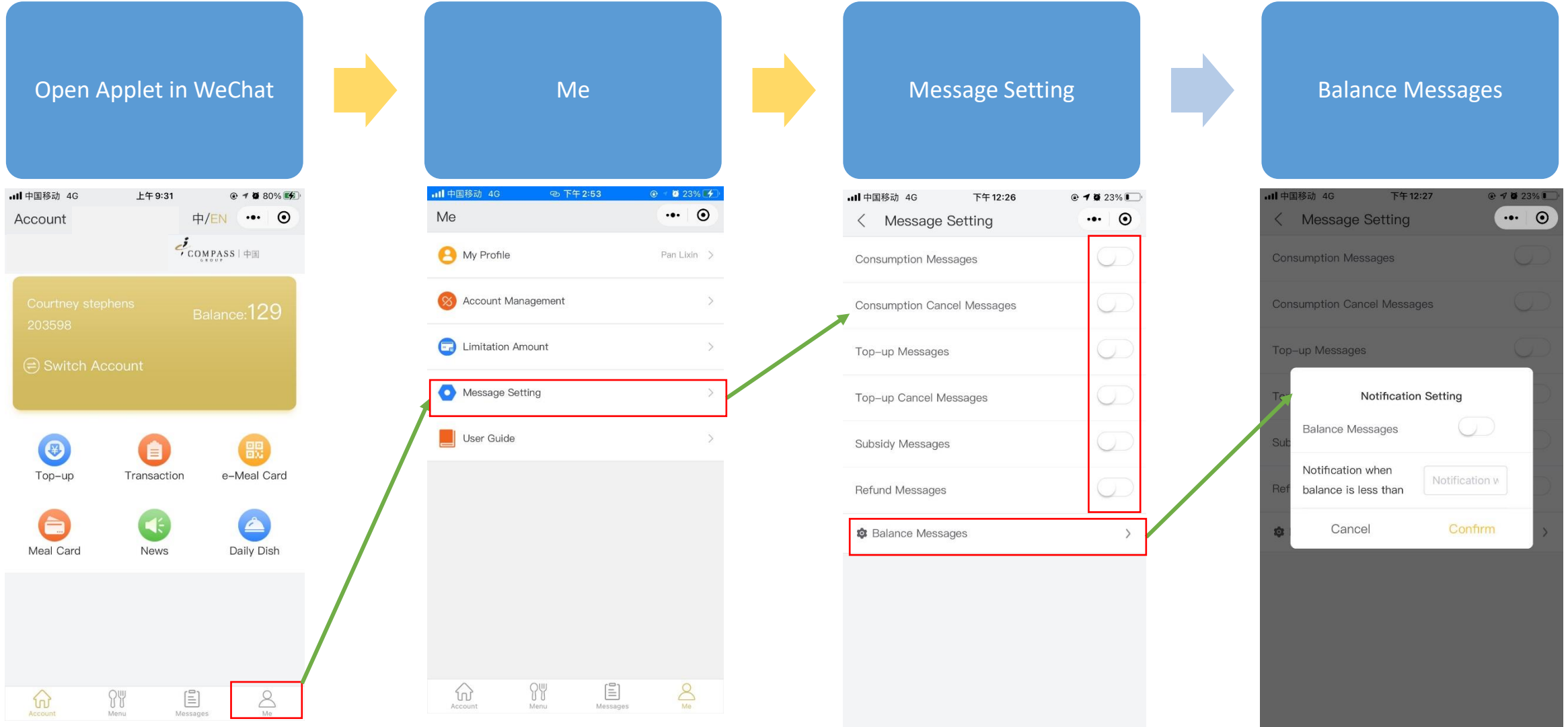

Consumers/Parents could understand how to use different functions by checking "User Guide".

